

Shaft assembly:

- Preassemble on the shaft:
 - Anti-blowout pin
 - Drive keys
 - Bottom bearing bushing
 - Ring
 - Insert the cross pin
-

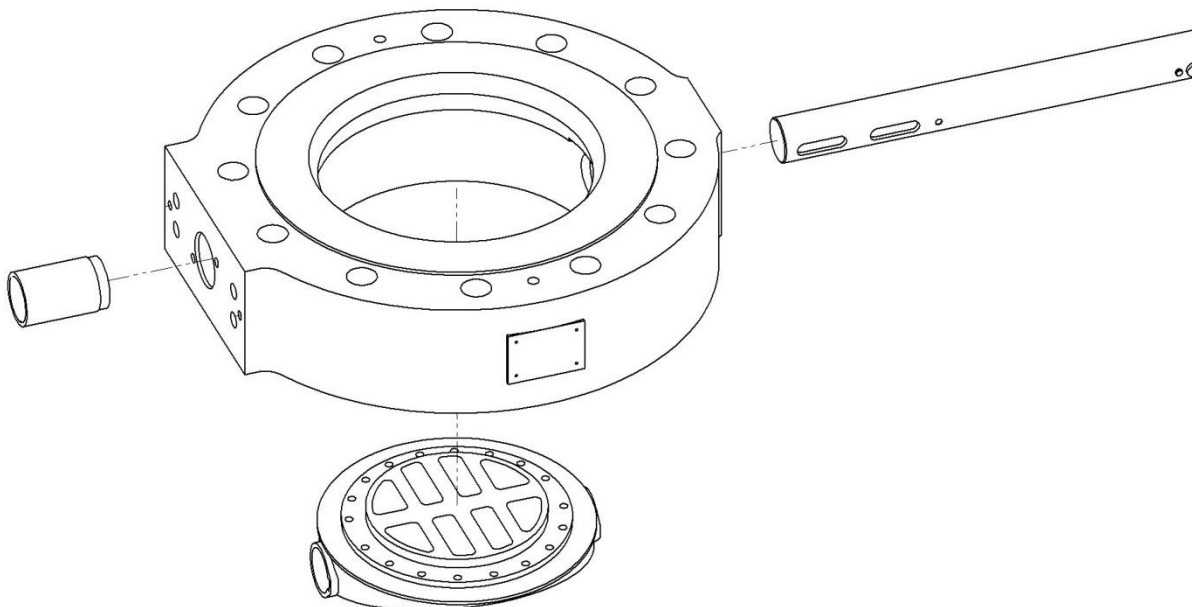

Disc assembly:

- Keyway of the disc must be on the nameplate side
 - Align the disc in the valve body
 - Insert the shaft into the bottom of the valve body, passing through the bore of the disc
 - Install upper bushing
 - Continue inserting until it until it stops
-

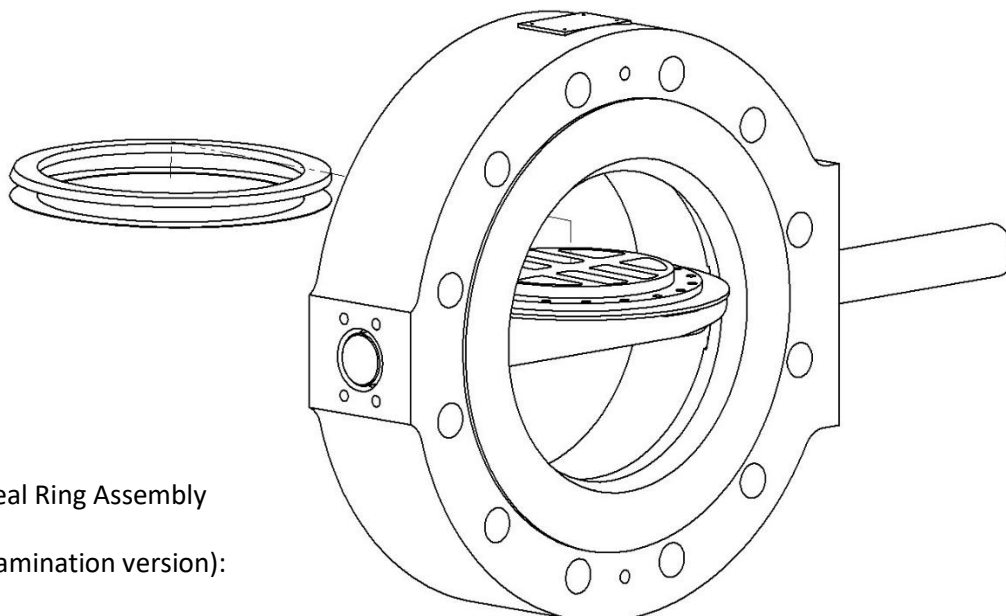

Seal Ring Assembly

(lamination version):

- Ensure the gasket surface on the disc is clean
- Place the graphite flat gasket onto the disc
- Place the laminated seal ring onto the flat graphite seal

(O-ring version)

- Ensure the gasket surface on the disc is clean
- Place both o-rings in the carrier (SELI)
- Place the seal carrier with both o-rings on disc

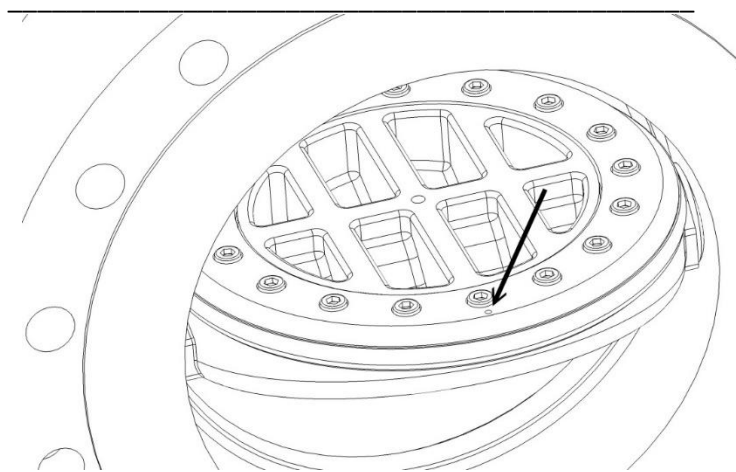
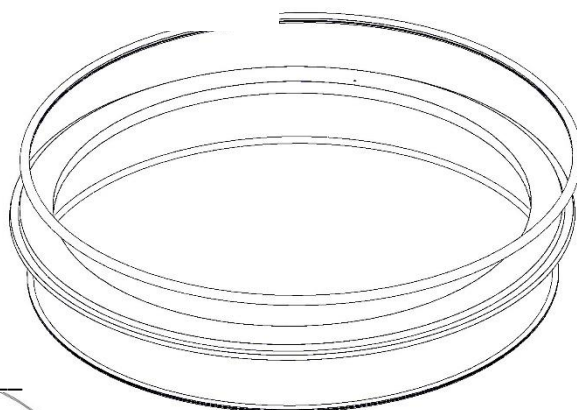

Clamping Ring Assembly:

- Align the seal ring so the marking on the disc, the seal ring, and the clamping ring match (arrow)
- Place the clamping ring onto the seal ring
- Insert the clamping ring screws and tighten them finger tight
- Close the disc slightly a couple times allowing the seal ring to find the correct position
- Once adjusted, tighten the clamping ring screws slightly more than finger tight

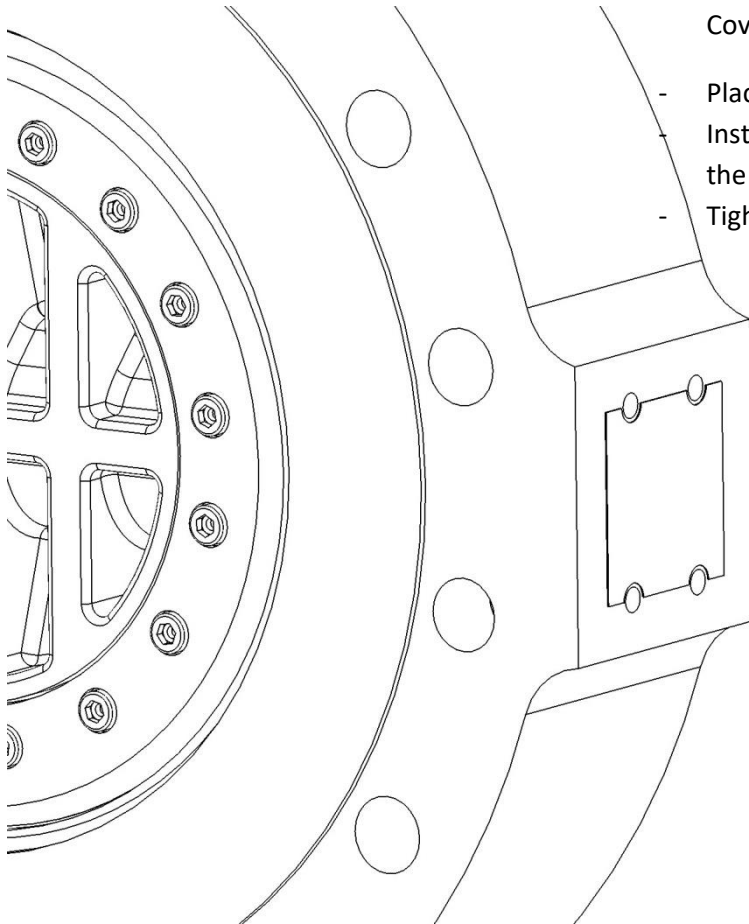

Cover Plate Installation:

- Place the flat gasket on the lid
- Install the cover on the valve body with the supplied bolting
- Tighten the screws to the torque specified

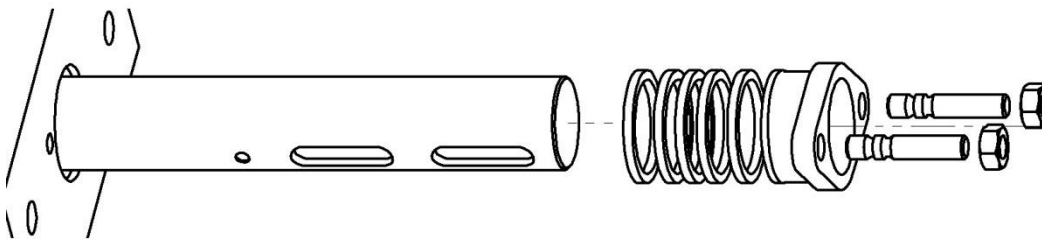
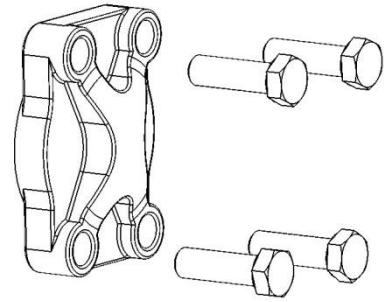

Stem Packing Installation:

- Insert one piece of the graphite braid lining up the angled ends to fit
- Insert the three solid graphite rings
- With the angled ends on the opposite side from of the first braid, insert the remaining braid
- Install the packing studs
- Install the packing gland
- Install the packing nuts (if live-loaded, install the Bellville washers before installing the packing nuts)
- Tighten the packing nuts to the torque specified

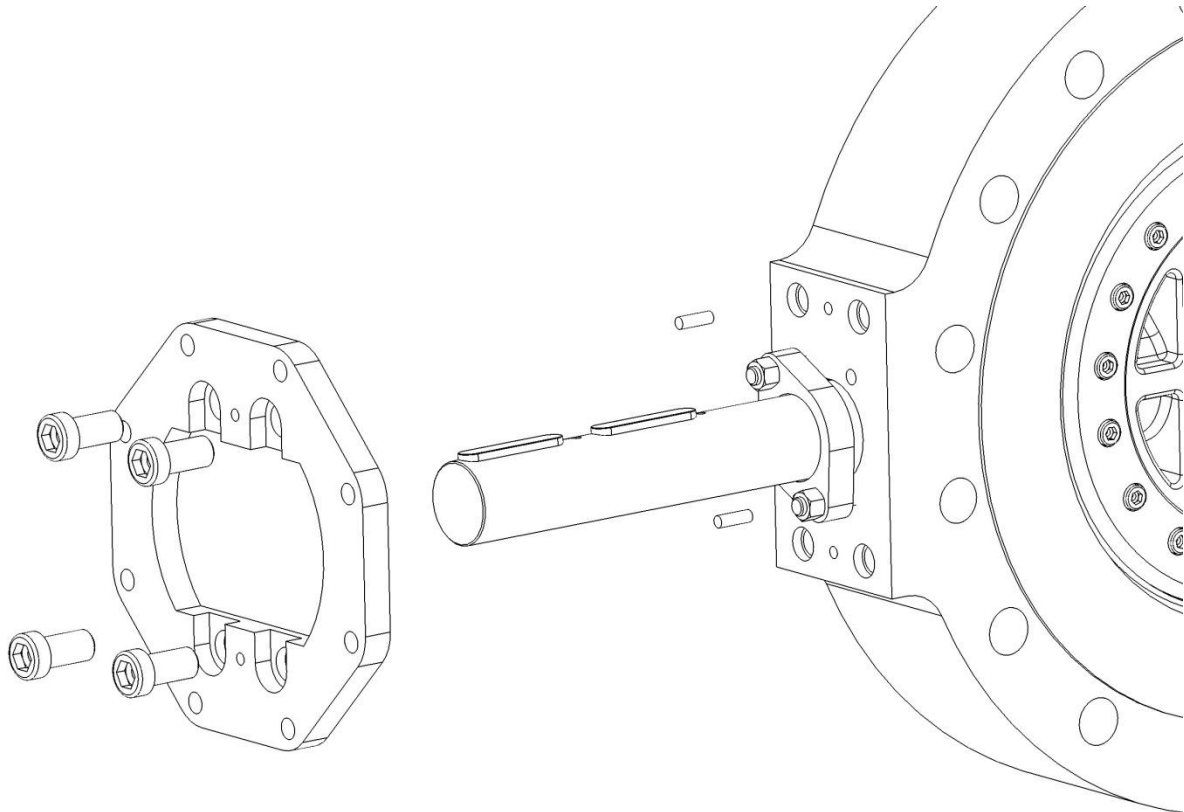

Install Mounting Ring:

- Insert the dowel pins into the valve body
- Place the mounting ring on the pins
- Insert the screws and tighten to the specified torque

-

Tighten the clamping ring screws:

- Install the gearbox and close the disc with a small torque
- Slightly tighten clamping ring screws with Your fingers in a "star pattern"
- Open disc
- Tighten clamping ring screws in a "star pattern" with specified torque
- Close disc with actuator with specified torque
- Tighten the clamping ring screws to final torque – again in a "star pattern"



Disassembly of the Top entry version:

- Close the valve
- Open the valve for 180°

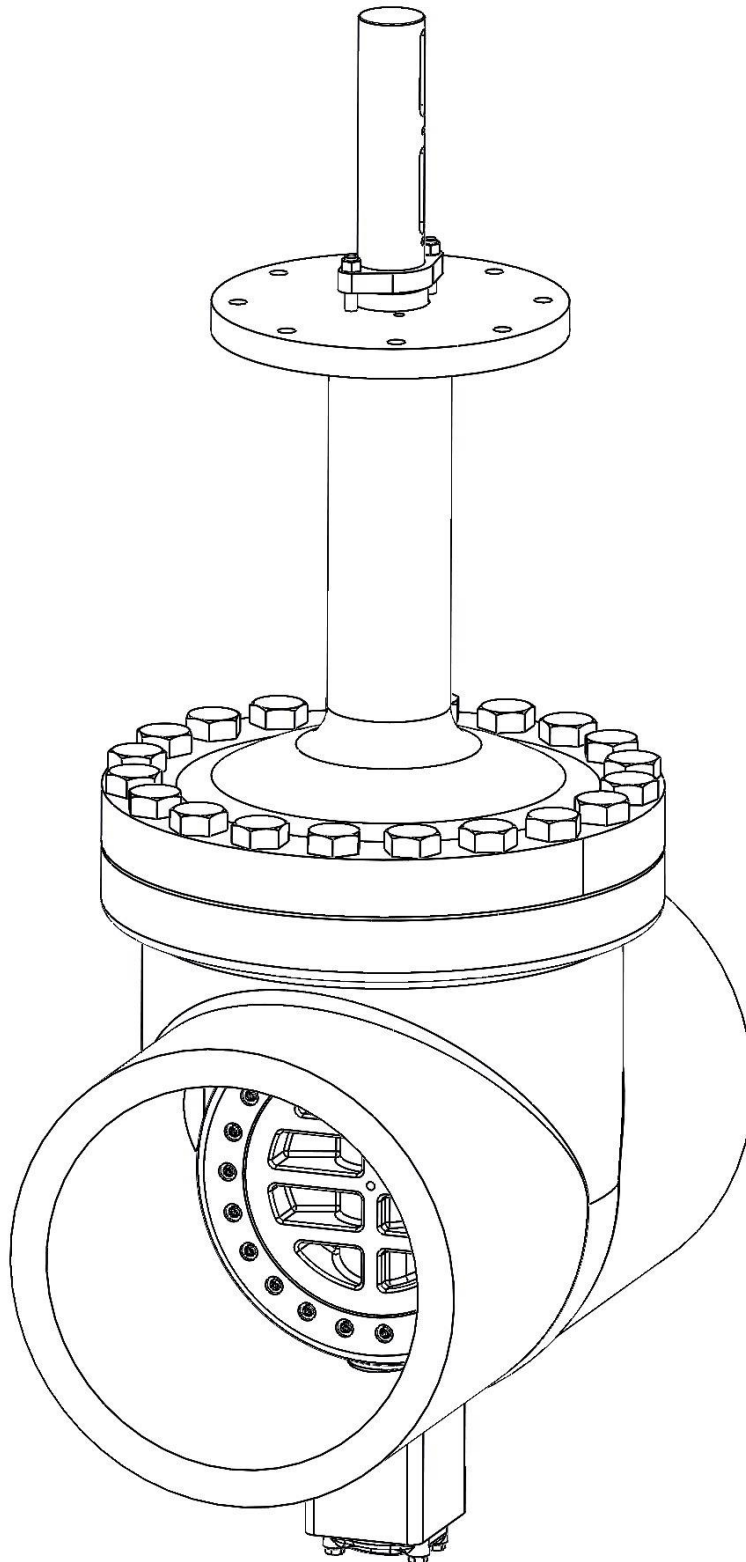



Remove the top flange bolts and lift the whole topflange assembly.

Caution! Lift the shaft, do NOT lift the top flange!

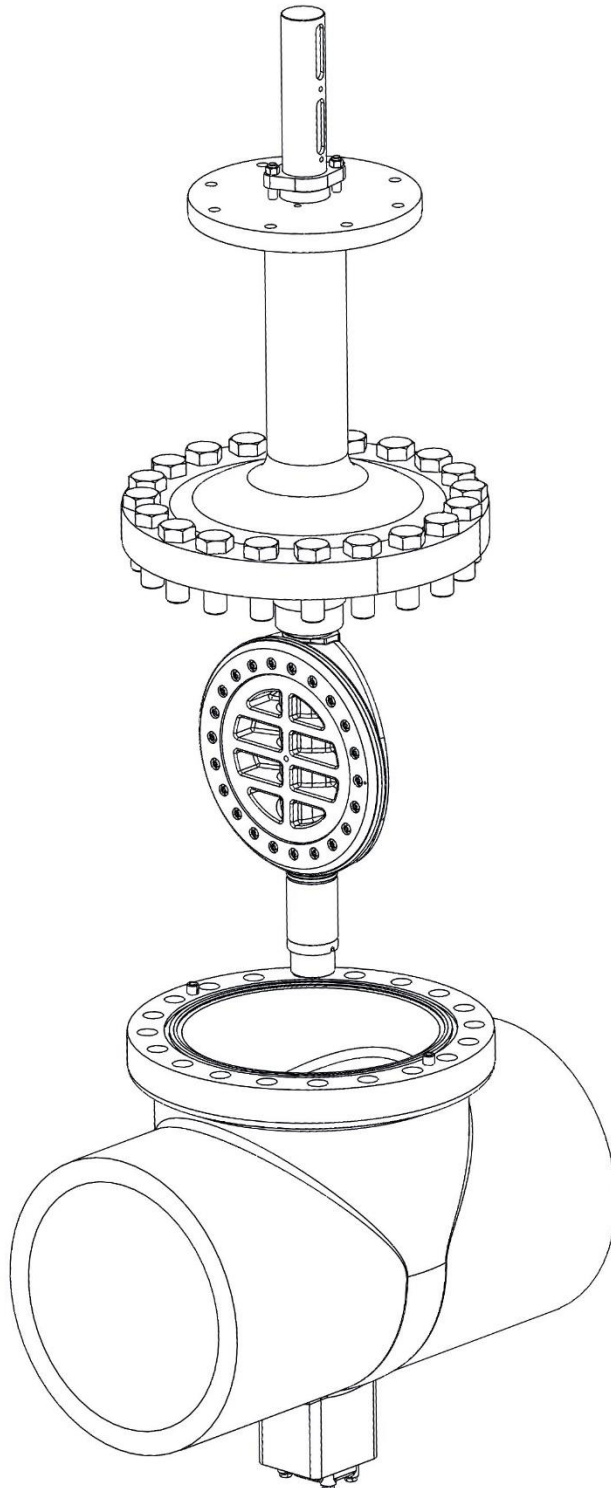



Remove the clamp ring screws

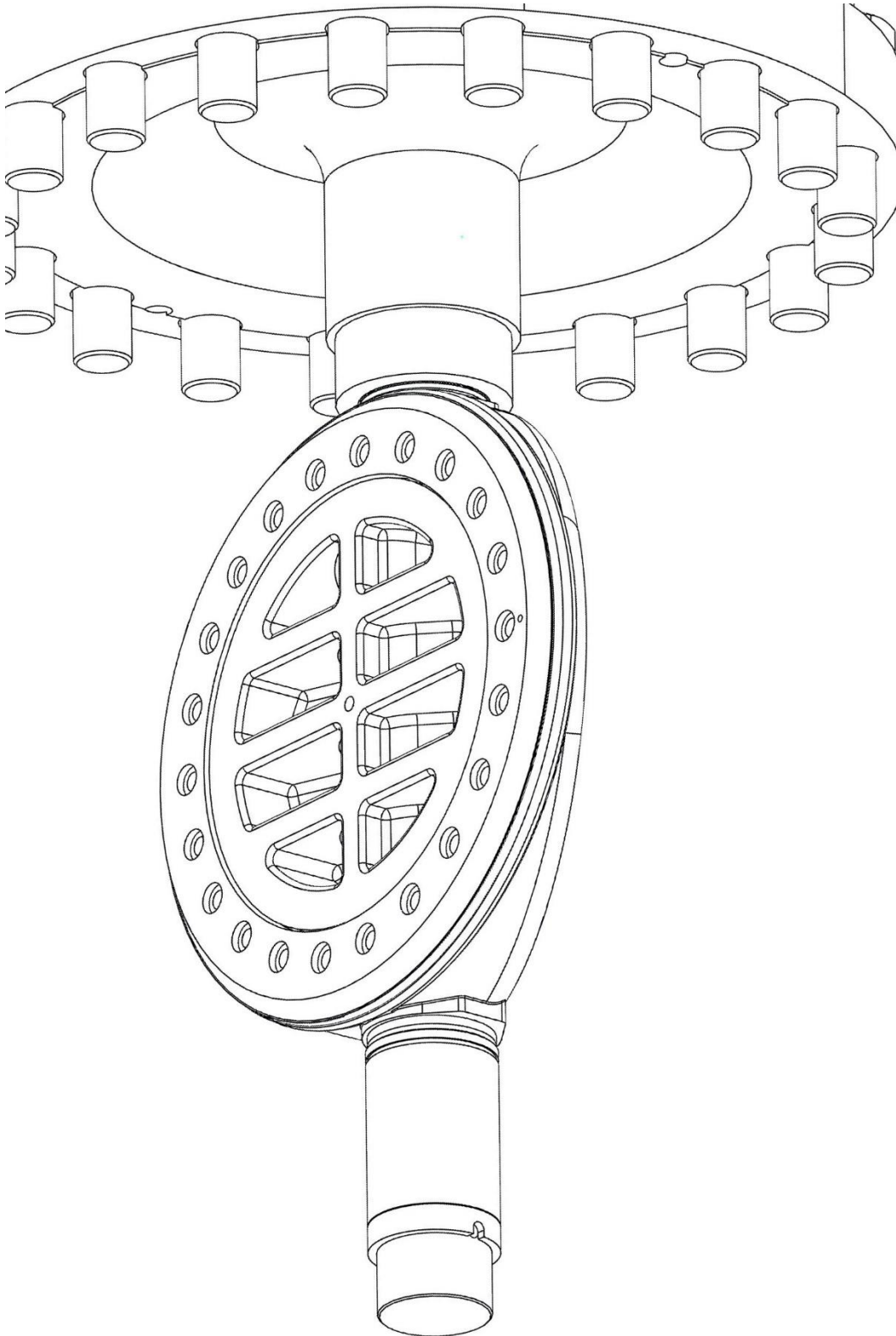



- Remove the seal ring carrier (SELI)
- Replace the O-rings

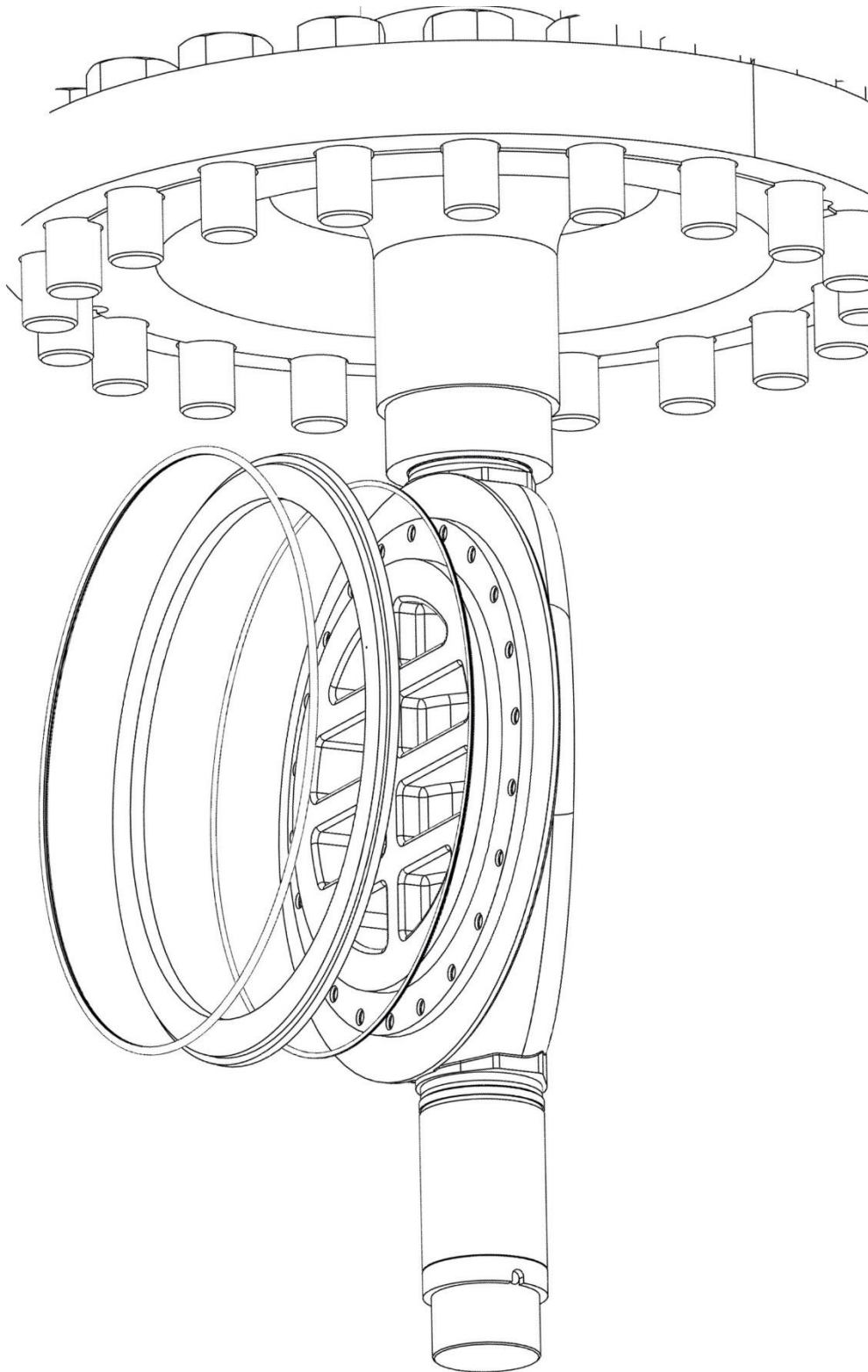

For assembly follow the instructions above